

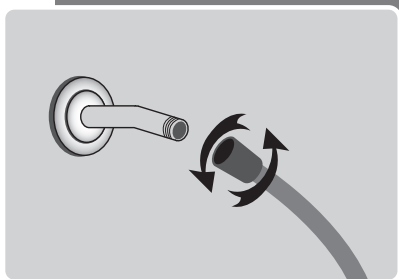

# SHOWER QUICK START GUIDE

## STEP 1

Remove your existing shower head. To remove, turn the existing shower head in a counterclockwise direction.

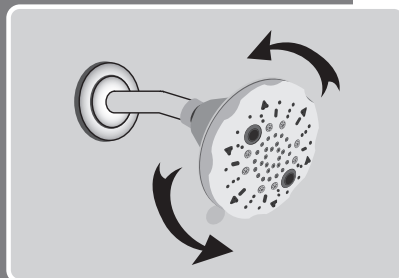

## STEP 2

Attach end of hose to shower arm and hand tighten.

## STEP 3

Attach ShampooPro to other end of hose and hand tighten. Enjoy!

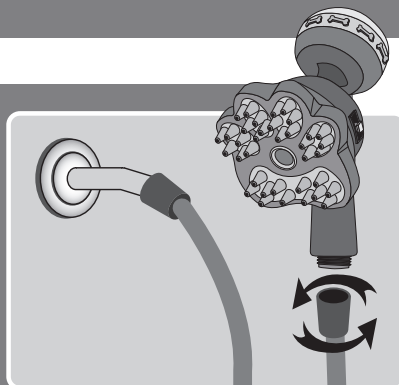

For use with automatic compensating valves rated at 1.35 GPM (5.11 L/min) or less.



# DUCHA GUÍA DE INICIO RÁPIDO

## PASO 1

Quite su cabezal de ducha existente. Para la extracción, gire el cabezal de ducha existente en el sentido contrario a las agujas del reloj.

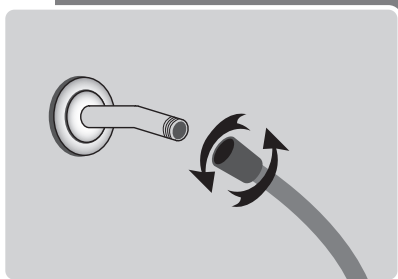
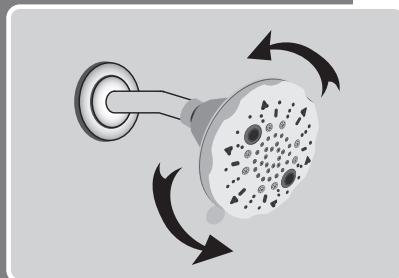

## PASO 2

Fije el extremo de la manguera al brazo de la ducha y ajuste a mano.

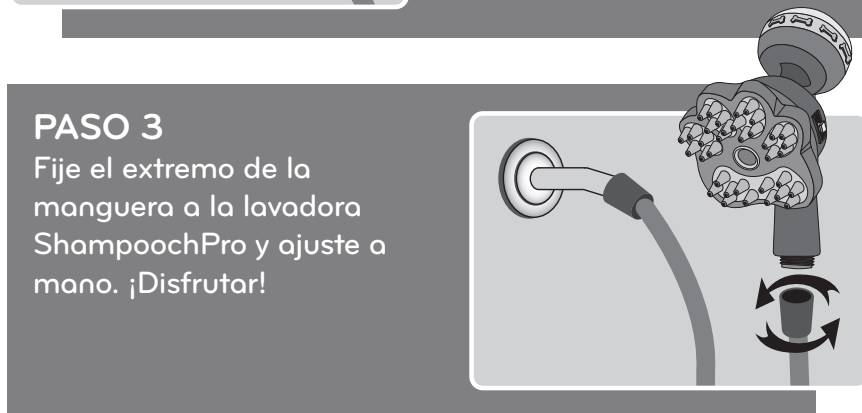

## PASO 3

Fije el extremo de la manguera a la lavadora ShampoochPro y ajuste a mano. ¡Disfrutar!

Para el uso con válvulas de compensación automáticas nominal de 1.35 GPM (5.11 L/min) o menos.